

February 16-17, 2019



# THE WEEKLY CONNECTION

## ONE IN JESUS...REACHING MANY!

Week of February 17, 2019

### WORSHIP CELEBRATION

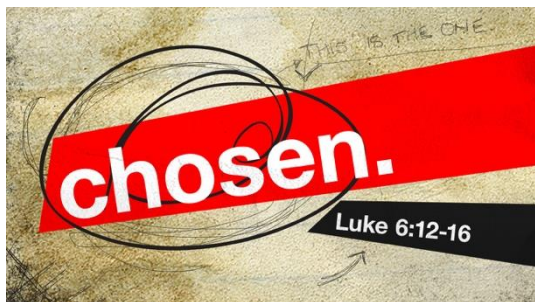

If you were intentionally pulling together a key group of leaders who would be entrusted to bring eternal hope to the world you would rightly want to choose wisely. You would seek the brightest and best. The most qualified and naturally talented with a proven pedigree. Yet, what is most amazing about the original disciples chosen by Jesus is that He even chose them at all! And so it with us! But be assured, His choosing inadequate, insecure, broken and even sinful people...actually shows there is hope for all of us and for the world!

**WORSHIP ATTENDANCE UPDATE** “And let us consider how we may spur one another on toward love and good deeds, not giving up meeting together... but encouraging one another—and all the more as you see the Day approaching.”—Hebrews 10:24-25

Attendance for February 9-10.....895

### BIBLICAL DISCOVERY

**NO SUNDAY SCHOOL** for THIS SUNDAY, February 17 as our leaders and volunteers take a break for Presidents’ Day weekend. Adult Bible Class will be held. Sunday School resumes Sunday, February 24.

**GET INTO THE WORD THIS WINTER** – There are many opportunities at St. John to grow in your faith through God's Word! From children to seniors, internationals to parenting, Bible basics to more in-depth studies—there is truly something for everyone no matter your age, life circumstances or schedule! Make this the year that you take a big step in your faith walk with Jesus! The *Get Into the Word* brochure with a full listing of Bible Class selections is available on our St. John website. Look for the homepage rotator that matches the graphic shown here. Printed copies of the brochure are also available in the Atrium and just outside Luther Hall. Let’s get into the Word together!



All articles submitted to *The Weekly Connection* will be subject to approval and editing by the staff. Articles may be sent via email to [connection@stjohnrochester.org](mailto:connection@stjohnrochester.org) and must be received no later than Wednesday at noon the week of publication.



**LAST CHANCE TO JOIN IN!** Are you ready to make St. John your church home? Have you or someone you know been searching for an opportunity to learn or rediscover what real faith in Jesus is all about in a non-threatening environment where your real questions can be

answered? Whether transferring from another church or brand new to the Christian faith, **The ONE Class** is for you! Come join Pastor Marc, Pastor Steve and Pastor Jon on a nine-week, action-packed journey through God's Word as they help you discover what Christian Lutheran faith is all about! They'll also introduce you to our St. John mission and vision. (Plus, you'll get a chance to meet other amazing people like you who also want to grow in relationship with Jesus!) The class meets on Monday evenings at 7:00 PM in Luther Hall (near the church sanctuary). Child care is available in the nursery. Class began on Monday, February 4, but you have one final opportunity to get started at the next session on Monday, February 18. Upon completion of the classes, participants will be welcomed to prayerfully consider official membership as part of the St. John family. For more information or to enroll, please visit our St. John website (look for the homepage banner slides) or contact the pastoral office at 248-402-8020 or [church@stjohnrochester.org](mailto:church@stjohnrochester.org). We hope to see you there!

## SHARED LIFE



**GRAB A CUP OF COFFEE AND INVITE A NEW FRIEND.** Following all our Sunday morning services, coffee and refreshments are served in Luther Hall. What a wonderful opportunity it is to get to know someone in worship with us. What a great way to be the church by encouraging each other in Jesus' name!

**TOMORROW, MONDAY, FEBRUARY 18,** the St. John facility and offices will be closed during regular business hours. However, the building will be open for any scheduled evening activities, including The ONE Class.

**OWLS (Older Wiser Lutherans in Service)** – The next meeting will be March 8 at noon in Concordia Hall. Please bring your own sandwich. We will provide coffee, water and dessert. The speaker will be announced later. Hope to see you then!

**GRIEFSHARE SUPPORT GROUP** – If you have lost a loved one and wonder if the feelings, frustrations, hurts, and loneliness you are experiencing are just you or whether others are going through the same things, then this study is a journey you need to be a part of. Using video, discussion, and prayer you will meet others with the same emotions and hardships who are trying to work through the grieving process. The next session of GriefShare started this Saturday, February 16 and will meet Saturday mornings. All are welcome! For more information, please contact Linda Baroli at 248-895-0310.



**FAMILY PRAISE AND PICNIC IN THE PARK SCHEDULED FOR AUGUST 25** - At its February 11 meeting, the Rochester City Council approved of the request from St. John for use of the Rochester Municipal Park for the annual Family Praise and Picnic in the Park celebration to be held Sunday, August 25. The initial Planning Meeting for this community worship, fellowship, and outreach event will be scheduled in May. If you would like to assist with this year's event, please contact Roger Guetzkow at 248-377-9048 or e-mail [rjguetzkow@comcast.net](mailto:rjguetzkow@comcast.net).

**ST. JOHN MOPS ANNUAL MOM TO MOM SALE** is just around the corner on Saturday, March 2, 8:30 AM - 1:00 PM in the gymnasium. Clean out your closets and basement of used baby and kids items, birth through size 16! We will have a big item room for outdoor toys, strollers, bikes, high chairs, beds, etc. For table rental information, please email [stjohnmopsm2m@gmail.com](mailto:stjohnmopsm2m@gmail.com).

## CHILDREN, YOUTH & FAMILIES



### ST. JOHN SCHOOL:

**Now Enrolling for 2019-2020:** Remaining space was opened up to the community starting Monday, February 4, as early school and congregation enrollment concluded on February 1. Application packets are available in the Admissions office, and an online application is available on our website. A completed application form and a non-refundable \$100 fee (cash or check) are required to start the enrollment process.

**Daytime Open House:** If you missed the enrollment events held earlier this year, or perhaps you need one more visit to confirm your enrollment plans, please join us for the Daytime Open House on Thursday, February 28, from 9:00 AM - 1:00 PM. All guests will be required to sign-in and will be accompanied by Admissions. Enrollment information will be available.

**St. John Lutheran School offers** Preschool to 8th grade in a Christ-centered setting firmly rooted in God's Word. The K – 8 program includes daily religion with weekly chapel, challenging academics, fine arts opportunities, and a variety of extra-curricular programs. Half and Full Day Kindergarten are available, and Young 5's will be offered starting with the 2019-2020 school year. For more information or to schedule a personal tour, contact Beth Dameron, Director of School Admissions at [bdameron@stjohnrochester.org](mailto:bdameron@stjohnrochester.org) or 248-402-8012, or visit [stjohnrochester.org/school](http://stjohnrochester.org/school).



**ST. JOHN FUTURE CITY TEAM TO COMPETE IN NATIONALS:** After taking 1<sup>st</sup> place in the Regionals in January, the St. John Future City team advances to the National Competition in Washington, D.C., February 16-19. Presenters Anna Bochenek, Emerson Kerska and Lily Myers will make the trip, along with alternate presenters Jake Mathews and Brandon Raikes, Engineer Educator Dr. Linda Gerhardt of GM, Engineer Mentor Mr. William Abramczyk of FCA, and Teacher Sponsor Mr. Tim Grothaus. Please join in wishing God's blessings to the team! To learn more about the program, visit [www.futurecity.org](http://www.futurecity.org).

**REGISTRATION NOW OPEN FOR VBS 2019:** This year's Vacation Bible School will be June 24-28, 9:00 AM – 12:00 PM. We are currently at 100 students. We will be capping our numbers at 500 this year. If you have a child who is 4 years old through entering 6<sup>th</sup> grade please register them today. VBS is an amazing week of fun and joy. \*\*Please note that this year's VBS will be led by St. John as always, but will be hosted at Lutheran High Northwest due to the building and renovation project on the St. John campus this summer. Many thanks to Lutheran High for hosting us this year! To register for VBS, visit [www.stjohnrochester.org/VBS](http://www.stjohnrochester.org/VBS).

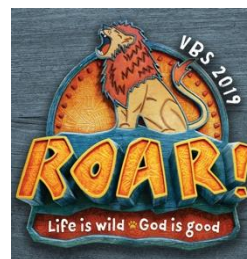

**SPRINGHILL DAY CAMP:** Due to construction plans, we will not be hosting a SpringHill Day Camp. If you are interested in your child attending a Springhill Day Camp, visit [www.springhillcamps.com](http://www.springhillcamps.com) for a list of available options.



#### **LIGHTHOUSE – MIDDLE SCHOOL MINISTRY GRADES 6-8**

Lighthouse is a place where Middle School students can feel safe and at home. It is also a place for students to bring their friends to share Jesus. Our activities include students in grades 6-8, and all are welcome! Lighthouse meetings are on Sundays from 6:00 - 8:00 PM. For more information, please contact Steve

Wilson, Director of Child and Family Ministry, at 248-402-8006 or [swilson@stjohnrochester.org](mailto:swilson@stjohnrochester.org).

**FIRST COMMUNION CLASS** - The sacrament of communion is an important part of a Christian's walk with Jesus. First Communion class is offered for those families interested in having their child (6th grade and older) take communion. Parents will need to attend the class sessions with their child and work together to decide if their child is ready to receive the sacrament. For more information, please contact Director of Child and Family Ministry Steve Wilson at [swilson@stjohnrochester.org](mailto:swilson@stjohnrochester.org) or 248-402-8006. Please sign up for the class on the St. John website. Click on Discover/Middle School. Classes are scheduled for March 3, 10, 17, 24.

**THE SPRING MIDDLE SCHOOL RETREAT** will be Friday-Sunday, March 15-17 at Cran-Hill Ranch. The cost of the event is \$100. The group will leave that Friday at 4:00 PM and return on Sunday at 4:00 PM. This retreat is a great opportunity to grow in faith and fellowship together through Scripture, as well as by enjoying ax-throwing, archery tag, and other fun activities. Go to <https://rebrand.ly/MSR> to register.



### **HIGH SCHOOL YOUTH –**

**WE REJOICE!** Thank you to the congregation and friends of St. John for tremendous support last weekend by attending the pancake breakfast. Funds raised from the breakfast support the youth group's efforts to raise money for their mission trips this year. Thank you also to Christine Wissburn & Laura Gilbert for helping in the kitchen. Last Sunday was also the youth group's PRAISE & WORSHIP service for students in grades 6-12. It was a precious night to share the message of VALUE. Thank you to Emily Stoll for providing her testimony.

This weekend, the youth are enjoying a trip to visit the ARK and worship with a local congregation in Williamstown, KY! Please pray for safe travels and an amazing trip!

For more information, please contact Melissa Hammett, Director of High School Youth Ministry, at 248-402-8008 or [mhammett@stjohnrochester.org](mailto:mhammett@stjohnrochester.org).

## **SACRIFICIAL GENEROSITY**

**PLEASE DON'T FORGET TO DIRECT YOUR THRIVENT CHOICE DOLLARS!** Grant funding from Thrivent Financial through its Thrivent Choice® program can help support organizations you care about... like St. John Lutheran Church & School! If you are a Thrivent Financial member, please don't let your Choice Dollars expire! Make a difference in Jesus' name by directing points toward our shared mission and ministry. Eligible Thrivent Financial members have until March 31, 2019 to direct any remaining 2018 Choice Dollars. Thousands and thousands of dollars for ministry are currently available but must be directed. Simply go to [Thrivent.com/thriventchoice](http://Thrivent.com/thriventchoice) to learn more. Or call 800-847-4836 and say "Thrivent Choice" after the prompt.

**FINANCIAL UPDATE**

“You will be enriched in every way so that you can be generous on every occasion, and through us your generosity will result in thanksgiving to God!” - 2 Corinthians 9:11. Thank you so much for your ongoing generosity that allows us to make an eternal impact in Jesus’ name!

**GENERAL MISSION & MINISTRY** Offerings for February 9-10.....\$41,815.10

Special Contributions for February 9-10... ..\$1,150.00

As of 2/10/18 Y.T.D. Budgeted Offerings: \$ 1,473,222.77

As of 2/10/18 Y.T.D. Actual Offerings: \$ 1,520,277.65

As of 2/10/18 Y.T.D. Variance to Budget: \$ 47,054.88

As of 2/10/18 Y.T.D. Special Contributions: \$14,436

*(St. John’s fiscal year is 7/1/18 through 6/30/19.)*

**ONE LEGACY INITIATIVE**

As of 2/14/19 Amount pledged..... \$3,463,734.79

As of 2/14/19 Amount received.....\$1,592,211.04



**ONE LEGACY INITIATIVE UPDATE**

Many thanks to everyone who attended the Congregation Forums on January 13 and 14. Your encouraging feedback indicating we are on the right path was very helpful as we prepare for construction to begin this spring on our exciting ONE Legacy Initiative campus

renovation and expansion project!

As was shared, a lot has happened since the \$8.5 million project was approved last May including:

- Labor rates, material costs and interest rates have risen dramatically requiring a reduction in our Phase 1 project scope to remain on budget.
- A mutual parting of ways with our initially chosen Construction Management firm.
- After an extensive interview and bid process with multiple firms, McCarthy-Smith has been brought on as our new Construction Management partner.

**Revised Scope and Timeline** - As further shared in greater detail at the forums, in recent weeks with the help of our architects and construction management partner, our team has been able to effectively reduce the scope of the project by a needed 15,000 square feet (to help realign our budget) while keeping the essence of the master site plan intact as much as possible. This has been accomplished by:

- Reducing the size of the new gym and maintaining the existing music room in the plan.
- Relocating most staff offices to a renovated administrative office area that will maximize existing square footage in lower level rooms 100, 101 and 102.
- A reduction in the size of the planned new office wing to the south maintaining it as school administration only.
- Decreasing extra square footage of the expanded Atrium space to the south.

As these plans are being finalized, so is our construction timeline. The project work is being planned in two specific phases in the coming months, with school renovations being the number one priority as we've allotted extra weeks off in this coming summer's schedule for construction to occur. This renovation work, beyond extensive facility improvements, will expand early childhood classroom space by four rooms for the coming school year.

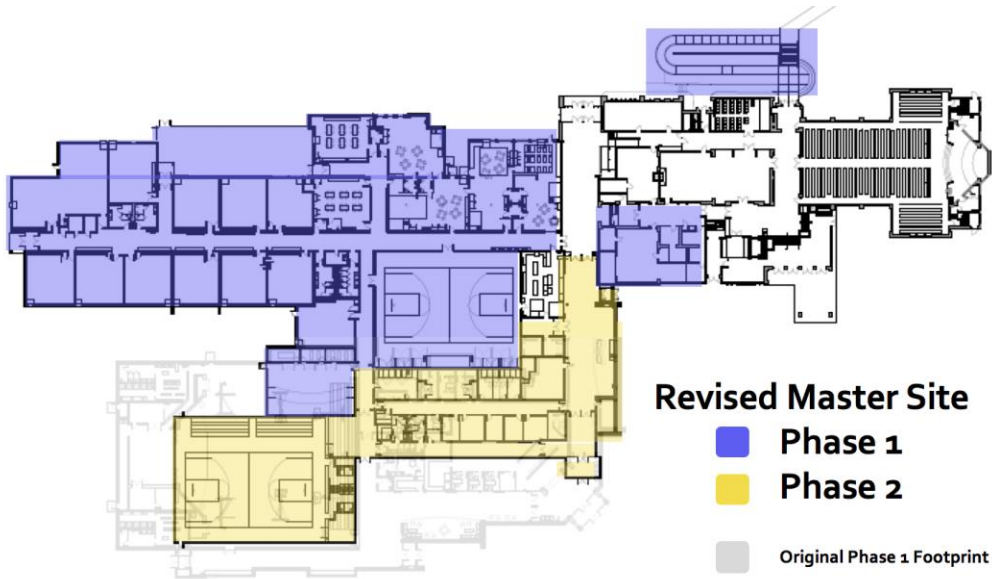

#### Phase 1 | Beginning Spring/Summer 2019

- Campus Site Work (utilities, parking lot expansion, water retention, front sanctuary plaza, etc. beyond what is shown in the illustration)
- Full Renovation of School and Lower Level Administration Office Area

#### Phase 2 | Beginning Fall/Winter 2019

- New Construction of Gymnasium, School Administration Offices, and extended Atrium spaces.

While very exciting, much will be involved in the upcoming months of extensive construction that will require a great deal of flexibility in normal campus operations and ministry activities. However, any temporary inconvenience will be well worth it as the Lord positions us to make an even bigger impact on our community into the future!

**Sacrificial Generosity Continues** - We remain beyond grateful for the generous response and demonstration of sacrificial giving so many of you have made in response to your Savior's love! Please keep it coming! Every pledge and every gift (over and above your regular ongoing giving) makes a difference as we prepare to finalize our construction loan financing in the next few months, and every dollar given now will be one less dollar financed once construction begins this spring.

Please continue to pray for the Lord's guidance as we continue to make important steps together in all that is ahead!



## COMPASSIONATE SERVICE

**THE CHURCH HAS LEFT THE BUILDING - SPRING EDITION! SAVE THE DATE!** As hundreds from the St. John family had the amazing privilege and joy of serving our community last fall on October 6, we are excited to announce our next opportunity to serve on **Saturday, May 4!** Details will follow, but for now mark your calendar and start anticipating the excitement of serving and impacting the lives of others!



### **MEXICALI MISSION TRIP TRAINING CONTINUES!**

Excitement is building as our Mexicali student mission teams continue to gather in preparation for their upcoming Mexico mission trip that will occur over spring break. Please keep these amazing students and leaders in prayer, as well as the hearts of those they will go to serve in Jesus' name.

**THRIVENT ACTION TEAMS** - Want to do something positive to strengthen our presence in the community? Think you can organize a team or group to make it happen in 90 days or less? If your answer is “yes” to both, simply submit an application to Thrivent and once your idea is approved you'll receive up to \$250 in “seed money” to help cover expenses. Need inspiration? Here are some ideas for a valuable service, fundraiser, or educational activity: Deliver/serve meals to the needy/homebound, Conduct a food/toy/clothing drive, Clean up a river/park/roadway, Clean up after a disaster, Build a wheelchair ramp for the handicapped, Assist with landscaping for the elderly, Organize fundraisers such as a Lenten Dinner/Youth Breakfast, or Conduct an educational workshop on a subject such as identity theft. Applications for funding Thrivent Action Teams are available at [Thrivent.com](http://Thrivent.com). Thrivent members are eligible to submit two applications each calendar year.

## RELATIONAL WITNESS

**CLICK TO SHARE THE ETERNAL LOVE OF JESUS!** Did you know it's actually really easy to pass along sermon messages to family, friends, neighbors and coworkers? Simply visit our St. John website and visit the sermon message archive. From there, click to share video or audio of any message via email, Facebook, Messenger, etc.

## CONSTANT PRAYER

**WE WOULD LOVE TO PRAY FOR WHATEVER IS ON YOUR HEART.** To submit a prayer request, please text or email it to [prayer@stjohnrochester.org](mailto:prayer@stjohnrochester.org) at any time or fill out a Prayer Request Card and hand to an usher during worship. These requests are received by our pastors and are passed along when requested to be included in the weekly prayer list that is sent out to our prayer warriors and included in weekend worship.



### **THIS WEEK:**

**Guidance & Strength:** *Future City National Competition in DC on Feb 18 / Missionary Carol – in Cambodia / Missionary Michelle overseas / Jacob / John*

**Hope & Healing:** *Lois Timm – hospitalized with multiple injuries / Jack Parish (father of Stacey Zagrodzki & Ruth Parish) – upcoming lung surgery / Ryan Jankovich / Gary Miller (father of Lori Hehl) – inoperable cancer...Continued healing for: Marilyn Miller / Jerry Bantin / Hailey Noonan / Sarah Leinberger / Linda Madson / Jim Madson / Raymond Pauli and Linda Glisman / Elisabet Standfest (granddaughter of Lynn Standfest)*

### **LAST WEEK:**

**Thanksgiving:** *Great men's breakfast & devotion by Pastor Jon*

**Guidance & Strength:** *Sharon Barton / Next weekend's High School Youth ARK trip / Julie (sister of Angie Wornson)*

**Hope & Healing:** *Delphine Millenson / Jason Myers / Florence Raetzel / Darlene Schwartz – cancer treatment / David Center*

**Bereavement:** – “For the family of:” *Shirley Heins (funeral Tuesday morning at St. John)*

### **PRIOR WEEK:**

**Thanksgiving:** *Mike Spencer's life talk Sunday*

**Guidance & Strength:** *Calvin / John*

**Hope & Healing:** *David Center – pneumonia / Ryan Jankovich / Don Cox / Debra Jankovich /*

**Bereavement:** – “For the family of:” *Calvin Kaiser (brother of Carol Harrell) / KC Gay (Pastor Marc's brother's father-in-law)*

## THIS WEEK AT ST. JOHN

### OFFICE HOURS THIS WEEK

Monday: Closed due to holiday  
Tuesday - Friday: 8:00 AM – 4:30 PM

### FACILITY HOURS THIS WEEK

Monday: Facility closed except for  
scheduled bible studies  
Tuesday - Friday: 8:00 AM – 9:00 PM  
Saturday: 8:00 AM – 6:00 PM

#### Sunday

9:30 AM Adult Bible Study– Concordia Hall  
6:00 PM Lighthouse – Room 101  
6:00 PM High School Youth Night – Youth Room

#### Monday

7:00 AM **NO SCHOOL/President's Day**  
Men's Small Group (McCallum) – Church Library  
7:00 PM "The ONE" New Member Class – Luther Hall  
7:00 PM St. John Foundation Meeting – Church Library

#### Tuesday

9:30 AM Bible Basics Class – Mary Martha Room  
11:30 AM International Bible Class – Room 128  
1:00 PM ESL Class – Concordia Hall  
6:00 PM Preschool 3's Dad's & Grandpa's Night – Concordia Hall  
7:00 PM Women's Bible Study (A Study of David) – Church Library  
7:00 PM LifeLight (Hebrews) – Mary Martha Room

#### Wednesday

8:45 AM School Chapel – Church Sanctuary  
9:15 AM LifeLight (Hebrews) – Concordia Hall  
1:00 PM Women's Bible Study (The Shepherd With Me) – Concordia Hall  
1:00 PM Women's Bible Study (The Faithful) – Church Library  
6:30 PM Casual College – Oakland University Kresge Library

#### Thursday

10:00 AM Men's Small Group (Fedototszkin) – Church Library  
11:30 AM Hannah Circle Meeting – Mary Martha Room  
4:30 PM Skit & Drama Ministry for Kids – Luther Hall  
6:00 PM Jubilate Bell Choir Rehearsal – Choir Rehearsal Room  
7:15 PM Mixed Choir Rehearsal – Choir Rehearsal Room  
8:00 PM Alcoholics Anonymous – Concordia Hall

#### Friday

8:00 AM LCEF Savings Stamp Sales – Atrium  
9:00 AM ESL Class – Concordia Hall

#### Saturday

8:00 AM Bibles & Basketball – Gymnasium  
10:00 AM GriefShare – Church Library



**Worship Celebration Schedule**

Traditional Praise: Sundays @ 8:00 AM | 9:30 AM | 11:00 AM  
Modern Praise: Saturdays @ 5:00 PM | Sundays @ 10:45 AM

**1011 W. University Dr. | Rochester, MI 48307 | 248.402.8000 | [www.stjohnrochester.org](http://www.stjohnrochester.org)**